

Habitat Map South Central Nevada Local Planning Area

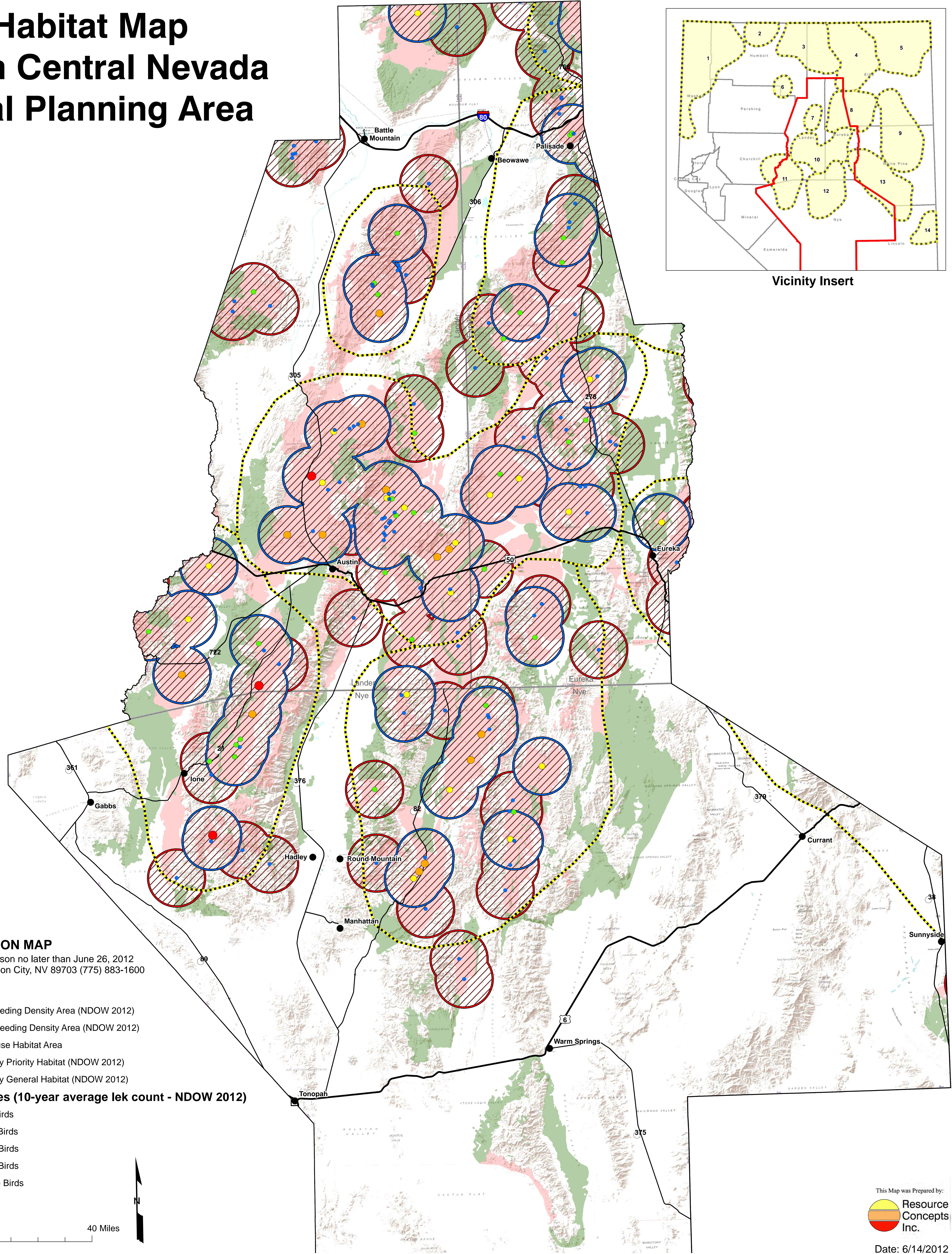
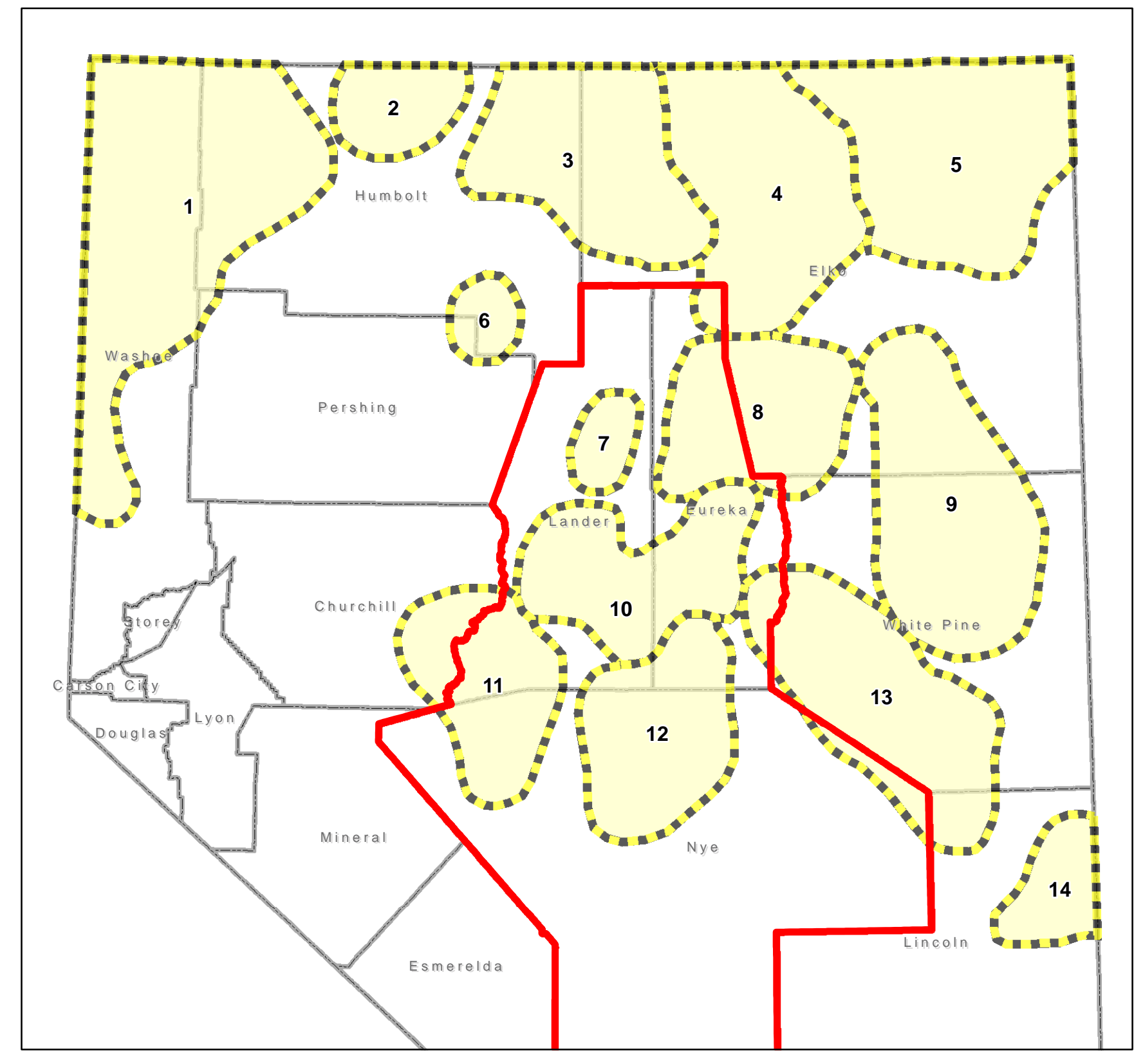

REVISION MAP

Please return to Don Henderson no later than June 26, 2012
340 N. Minnesota Street, Carson City, NV 89703 (775) 883-1600

Legend

- 85% Sage-grouse Breeding Density Area (NDOW 2012)
- 100% Sage-grouse Breeding Density Area (NDOW 2012)
- Preliminary Sage-grouse Habitat Area
- BLM/USFS Preliminary Priority Habitat (NDOW 2012)
- BLM/USFS Preliminary General Habitat (NDOW 2012)

Sage-grouse Lek Sites (10-year average lek count - NDOW 2012)

- 1-10 Breeding Male Birds
- 11-20 Breeding Male Birds
- 21-30 Breeding Male Birds
- 31-50 Breeding Male Birds
- 51-100 Breeding Male Birds

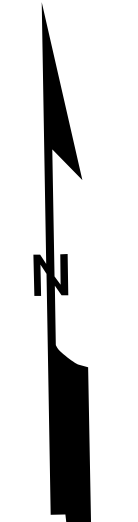
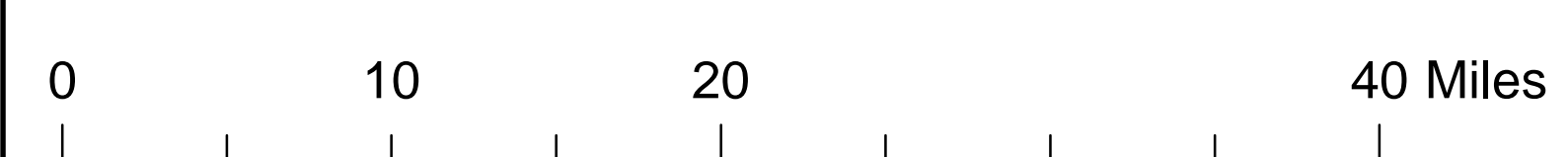

Path: R:\projects\NDOW12_133_1\MXDs\South_Central\South_Central_habitat.mxd